

---

# Avalon Promenade and Gateway

PARK AND BRIDGE CONCEPTUAL  
DESIGNS

DATE

DECEMBER 5, 2017

PREPARED FOR



PREPARED BY

**TY·LIN**INTERNATIONAL

# Agenda



1. Introductory Remarks
2. Workshop #1 Overview
  - Summary of Meeting
  - Questionnaire Results
3. Preferred Alternatives
  - Entry Plaza
  - Pedestrian Bridge
4. Park Features
5. Next Steps

# Design Workshop #1 | WILMINGTON WATERFRONT DEVELOPMENTS



## Purpose

1. Share major components of the project
2. Get feedback from the public

## Objectives

1. Connectivity
2. Iconic
3. Celebrate Wilmington
4. Sustainable Promenade
5. Commercial Opportunities

# Design Workshop #1 | PROJECT COMPONENTS

- ENTRY PLAZA
- PARKING
- AVALON PROMENADE
- OPEN SPACE
- PEDESTRIAN BRIDGE

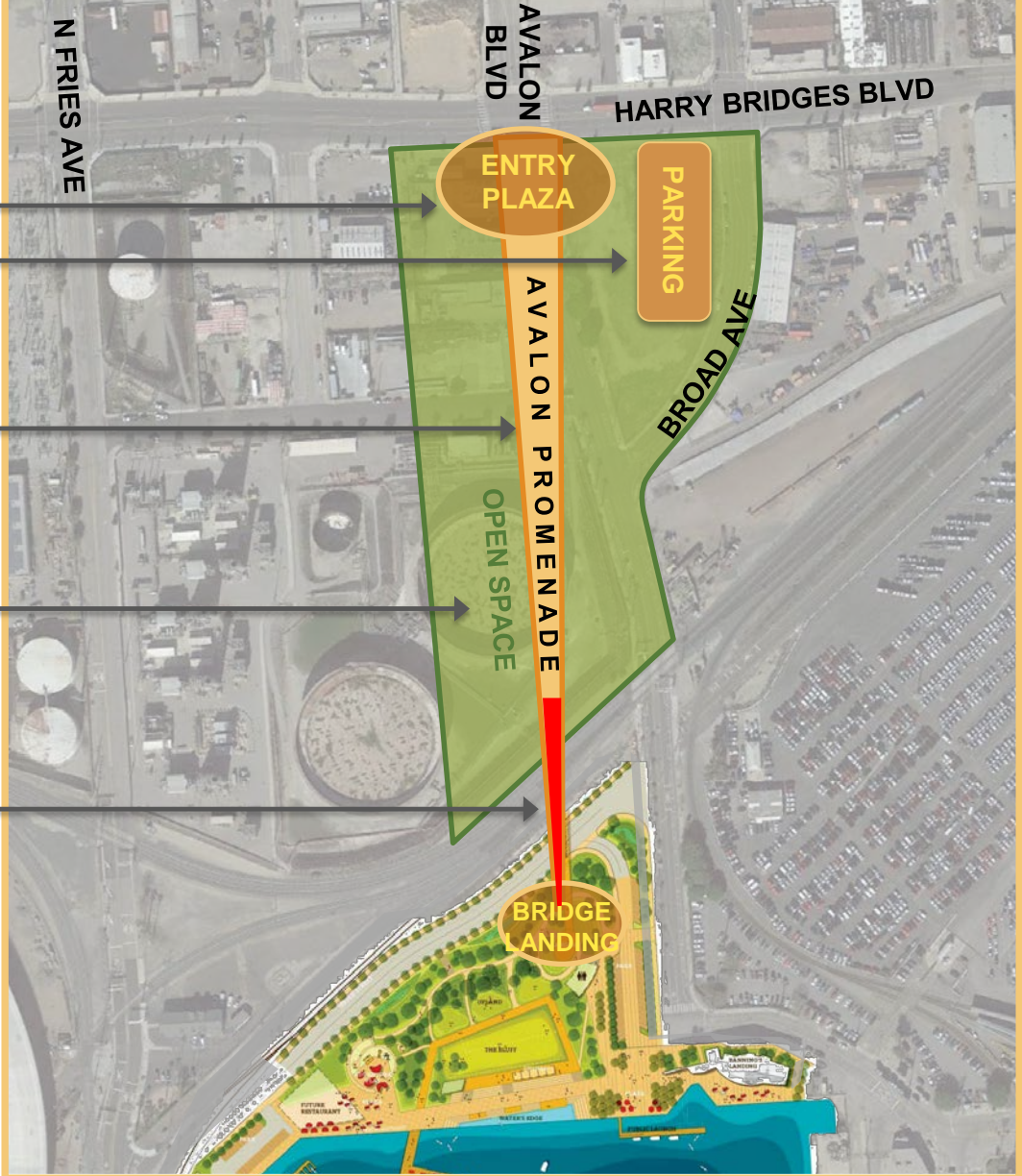

# Questionnaire Results | OVERVIEW

1. # Attendees at Meeting
2. Purpose
  - Presentation
  - Break out Workshop
3. Feedback Period June 6, 2017-July 24, 2017
4. Completed Questionnaires – 559 Paper and Online
5. Hardcopy Questionnaires – 82
6. Online Questionnaires – 477



# Questionnaire Results | OVERVIEW



## Avalon Promenade and Gateway

Port of Los Angeles | Wilmington, CA

### Design Workshop Questionnaire

Name

Email

#### Entry Plaza

We are trying to get a feel for what type of entry plaza you would like the most. Please **rank the examples** in order from best to least favored by assigning numbers **from 1 to 4** in the empty circles.



#### Avalon Promenade Open Space



Should the open space area feature more **active** or **passive** spaces? Please **check** the type you would like the most.



#### Pedestrian Bridge

Now, what **bridge type** did you like the most? Please rank them in order from best to least favored by putting numbers from **1 to 5** in the empty circles.

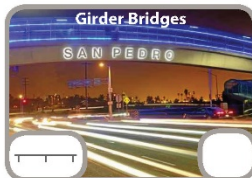

#### Parking

Where do you think the **best parking location** would be? Please rank them in order from best to least favored by writing numbers from 1 to 3 in the empty spaces provided.

#### Commercial Opportunities

Would you like to see **commercial opportunities**?

Yes?  or No?

#### Method of Transit

Please **check** how you will most likely **travel to the project site**.

Bike  Car  Walk  Other

#### History & Education

What **type of information** would you like to be included along the Avalon Promenade? Please **check** the one that is the most important to you.

Wilmington History  Coastal Nature  POLA History & Fun Facts

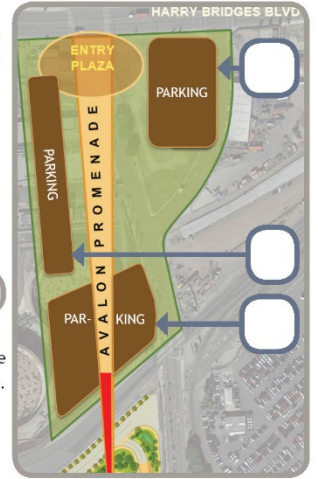

#### Landscape Theme

Please **rank the style of landscape** from best to least favored by numbering them **1 to 3**.



Rural



Ordered



Rolling

#### Additional Comments

# Questionnaire Results | ENTRY PLAZA

What type of entry plaza do you prefer?





## Should the open space area feature more active or passive spaces?

Overall Open Space Preference

Active

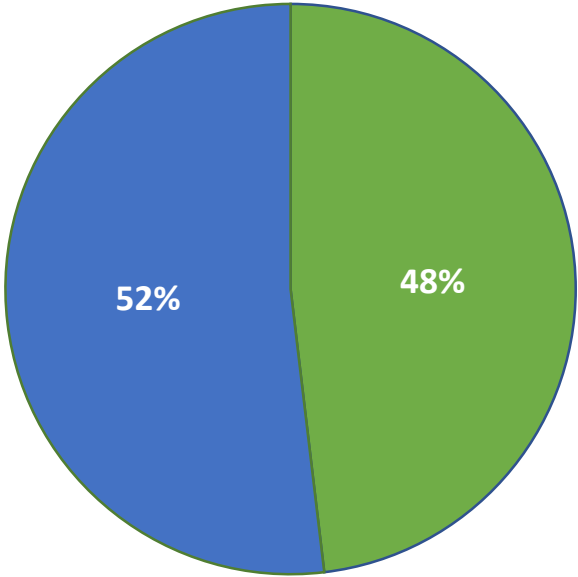

Passive



# Questionnaire Results | PEDESTRIAN BRIDGE

What bridge type did you like the most?

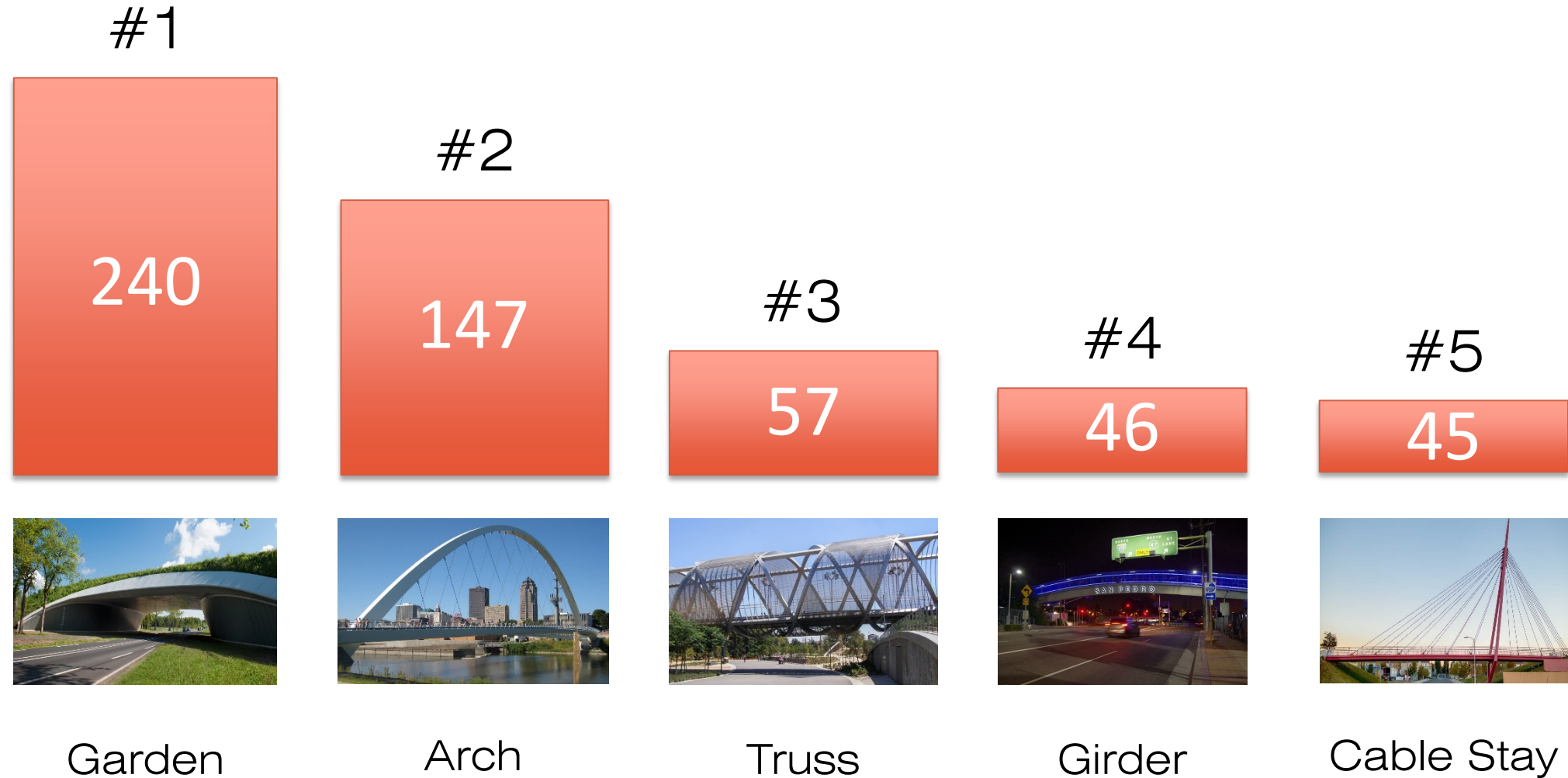

# Questionnaire Results | PARKING

Where do you think the best parking location would be?

Parking

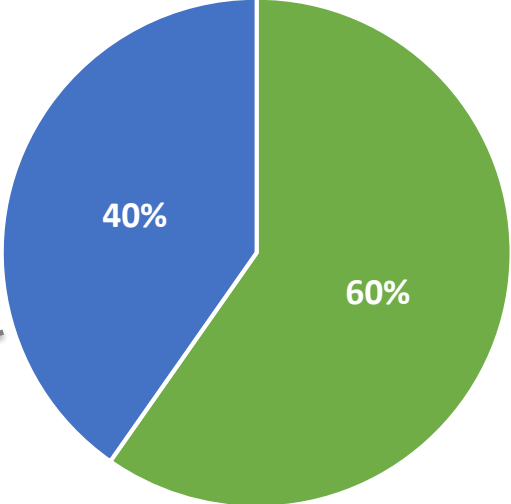

Closer to the waterfront Promenade (South)



Closer to the entry plaza and Harry Bridges Blvd (North)

## Would you like to see commercial opportunities?



Commercial Opportunities

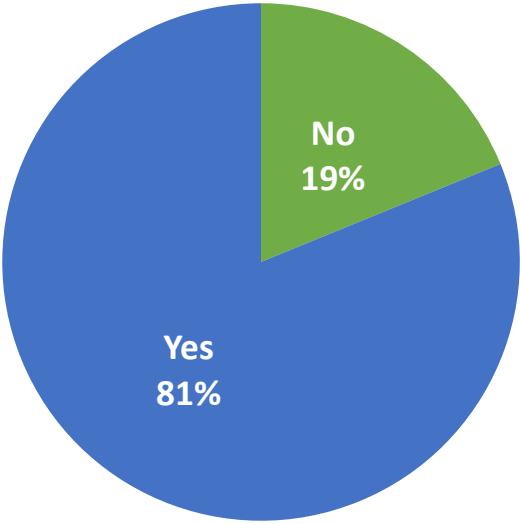

# Questionnaire Results | HISTORY & EDUCATION

What type of information would you like to be included along the Avalon Promenade?

POLA History & Fun Facts



Coastal Nature

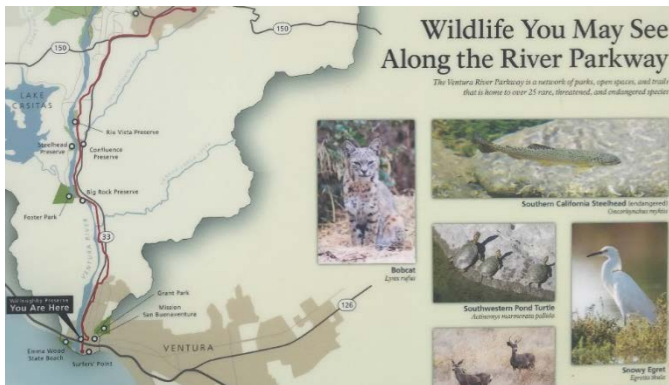

History & Education

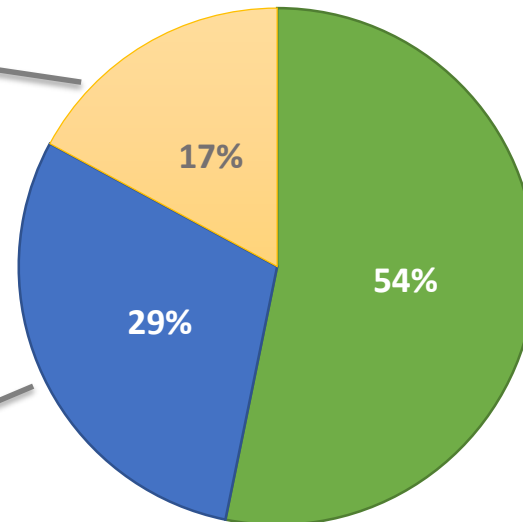

Wilmington History



# Design Workshop #2 | PURPOSE

1. Collect Feedback on Entry Plaza
2. Collect Feedback on Pedestrian Bridge

# Entry Plaza Alternatives |

# A. WHIMSICAL ENTRY



# Entry Plaza Alternatives

## PLAZA

# A. WHIMSICAL ENTRY

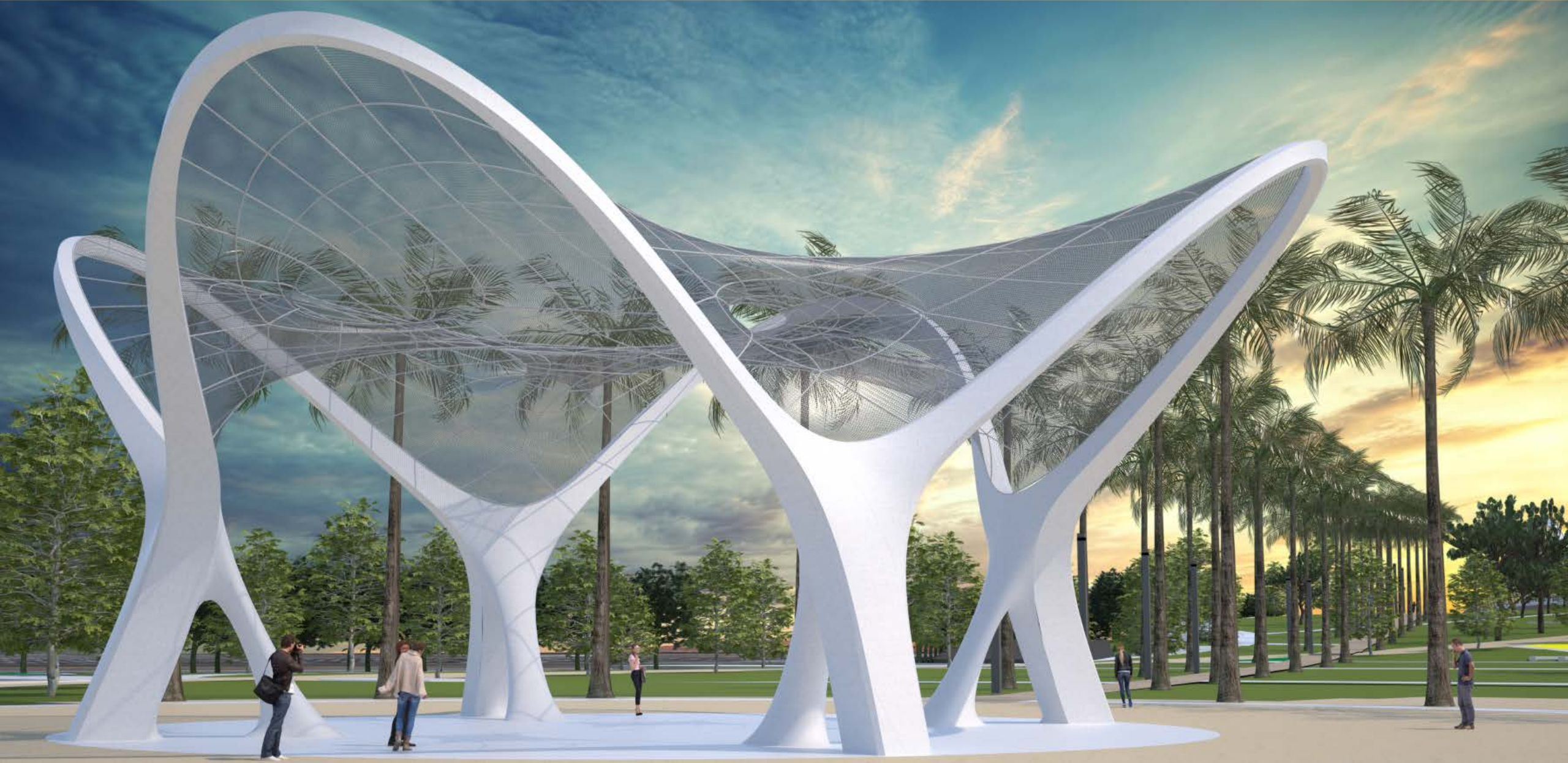



# Entry Plaza Alternatives

## PLAZA

# B.SCULPTED ENTRY

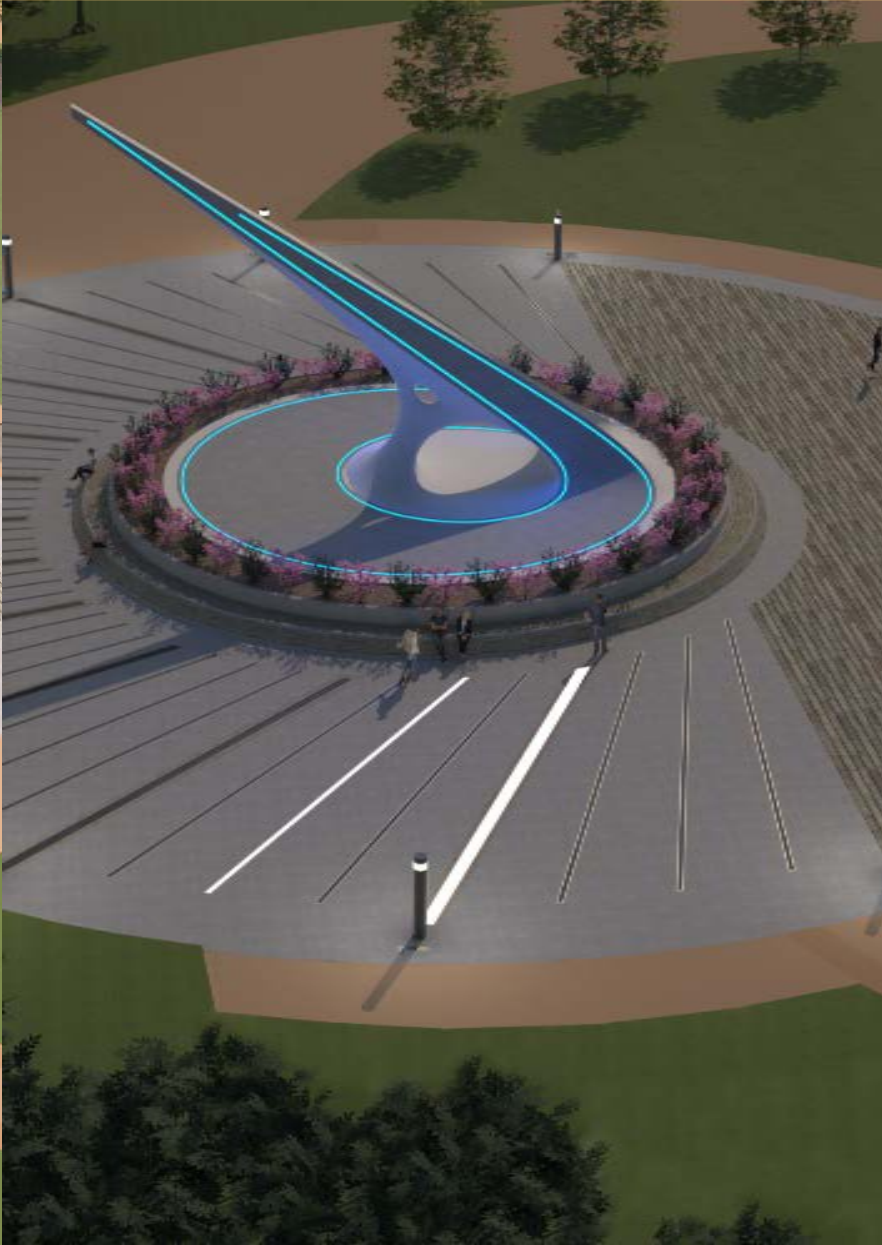
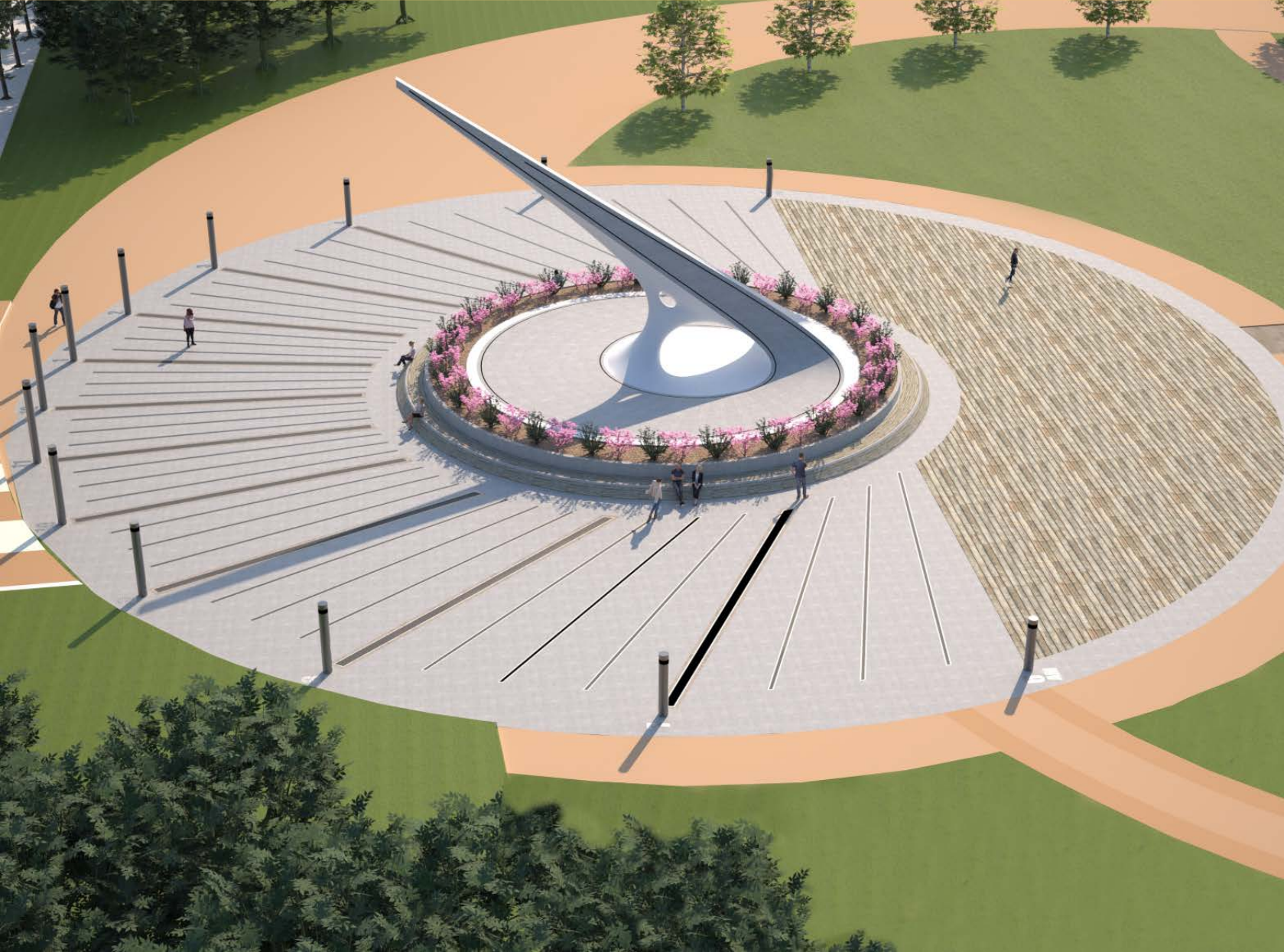

# Entry Plaza Alternatives

## PLAZA

# B.SCULPTED ENTRY



# Pedestrian Bridge Alternatives | A. GARDEN BRIDGE



# Pedestrian Bridge Alternatives | A. GARDEN BRIDGE



# Pedestrian Bridge Alternatives | A. GARDEN BRIDGE



# Pedestrian Bridge Alternatives | A. GARDEN BRIDGE



# Pedestrian Bridge Alternatives | A. GARDEN BRIDGE

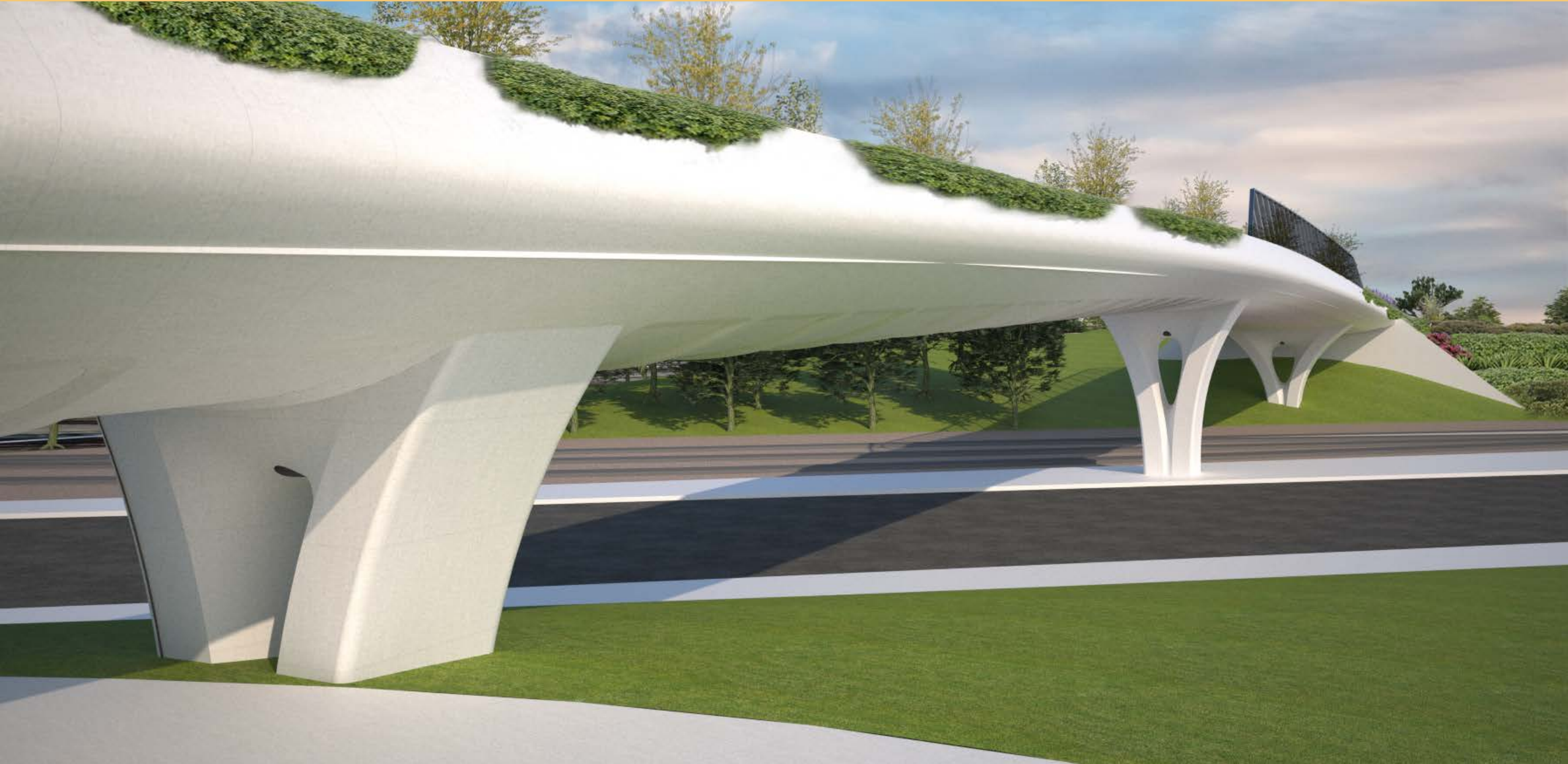

# Pedestrian Bridge Alternatives | B.ARCH BRIDGE





# Pedestrian Bridge Alternatives | B.ARCH BRIDGE



# Pedestrian Bridge Alternatives | B.ARCH BRIDGE



# Pedestrian Bridge Alternatives | B. ARCH BRIDGE

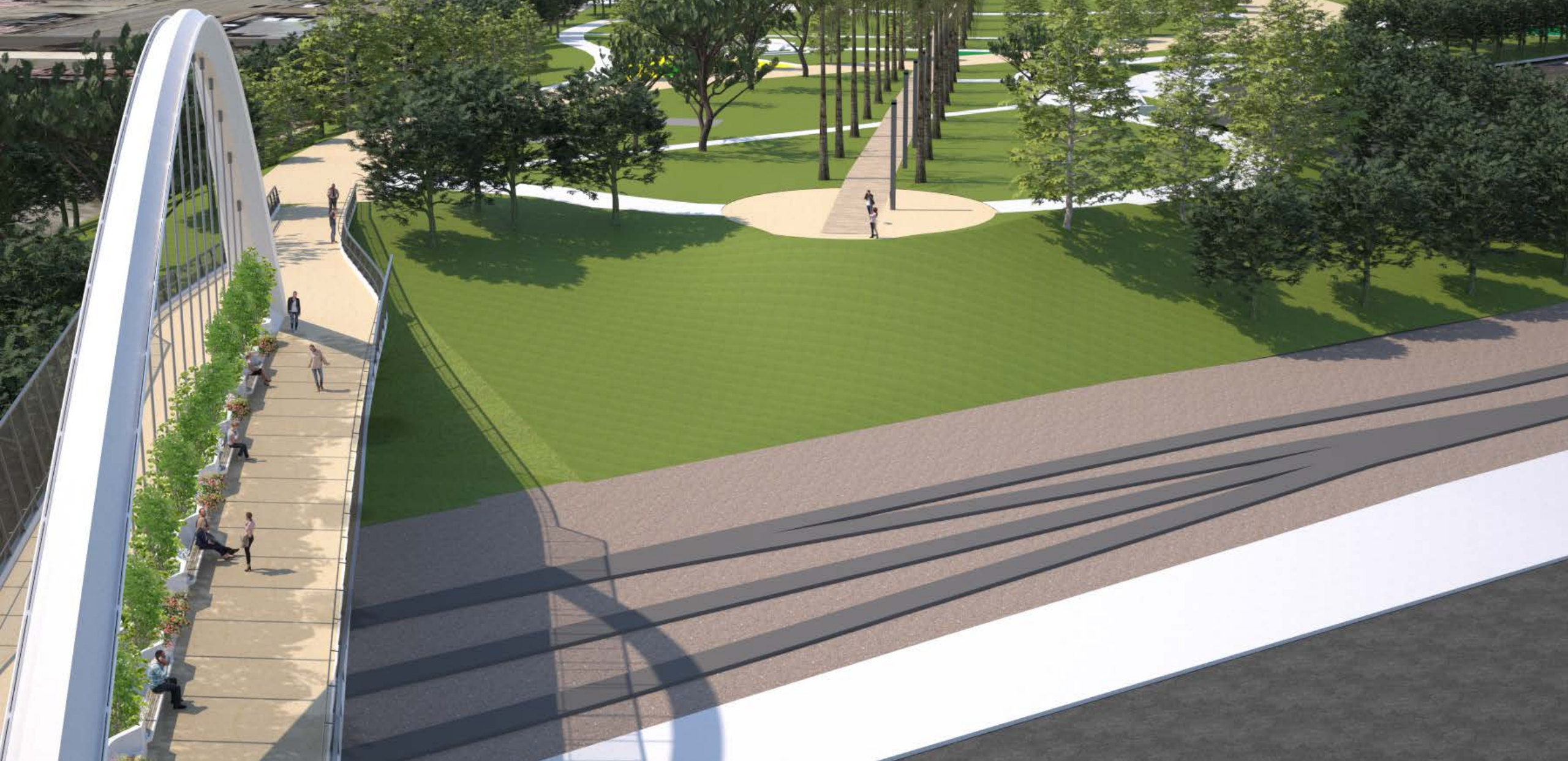

# Pedestrian Bridge Alternatives | B. ARCH BRIDGE

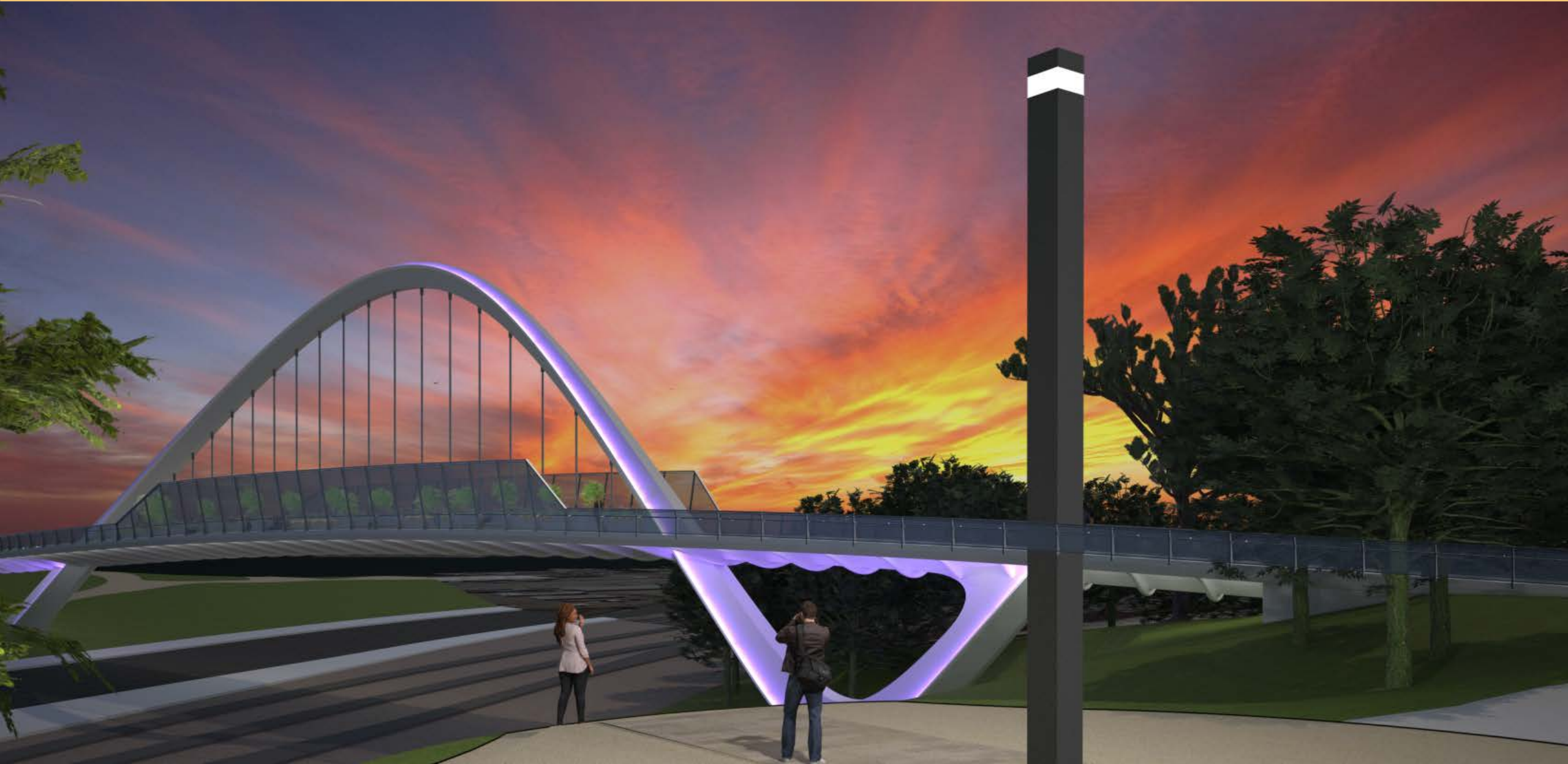

# Pedestrian Bridge Alternatives | B.ARCH BRIDGE

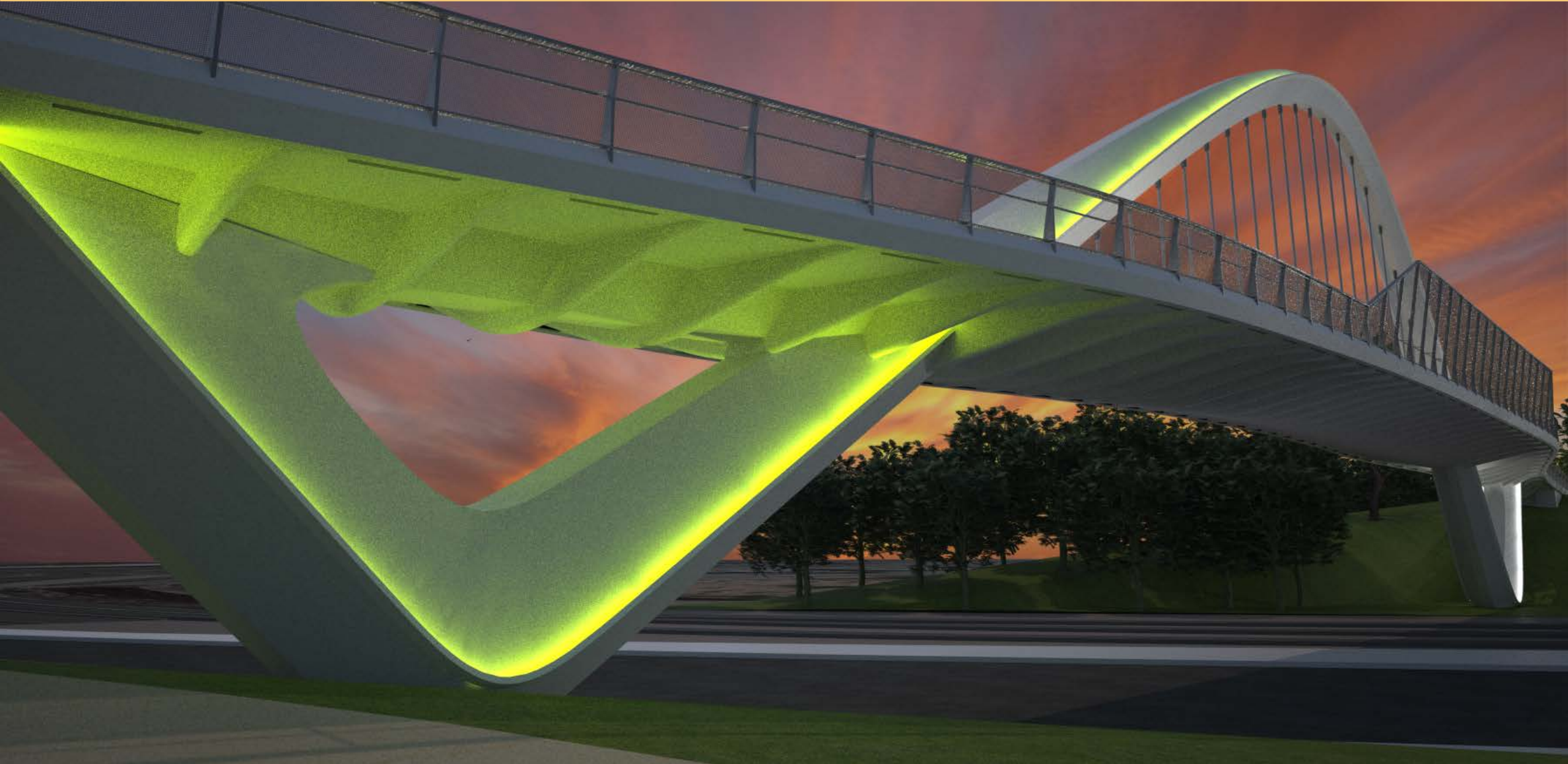

# Pedestrian Bridge Alternatives | B.ARCH BRIDGE



# Park Features |

# PASSIVE SPACE - TREE ALLEY AT HARRY

## BRIDGES BLVD



# Park Features | PASSIVE SPACE - FAMILY PARK





# Park Features

# ACTIVE SPACE - MULTI-PURPOSE TRAIL



# Park Features |

# ACTIVE SPACE - FITNESS IN THE PARK



# Park Features | EDUCATIONAL - AVALON HISTORY WALK



# Park Features | EDUCATIONAL - LEARN AND EXPLORE



# Park Features | PARKING & ACCESS

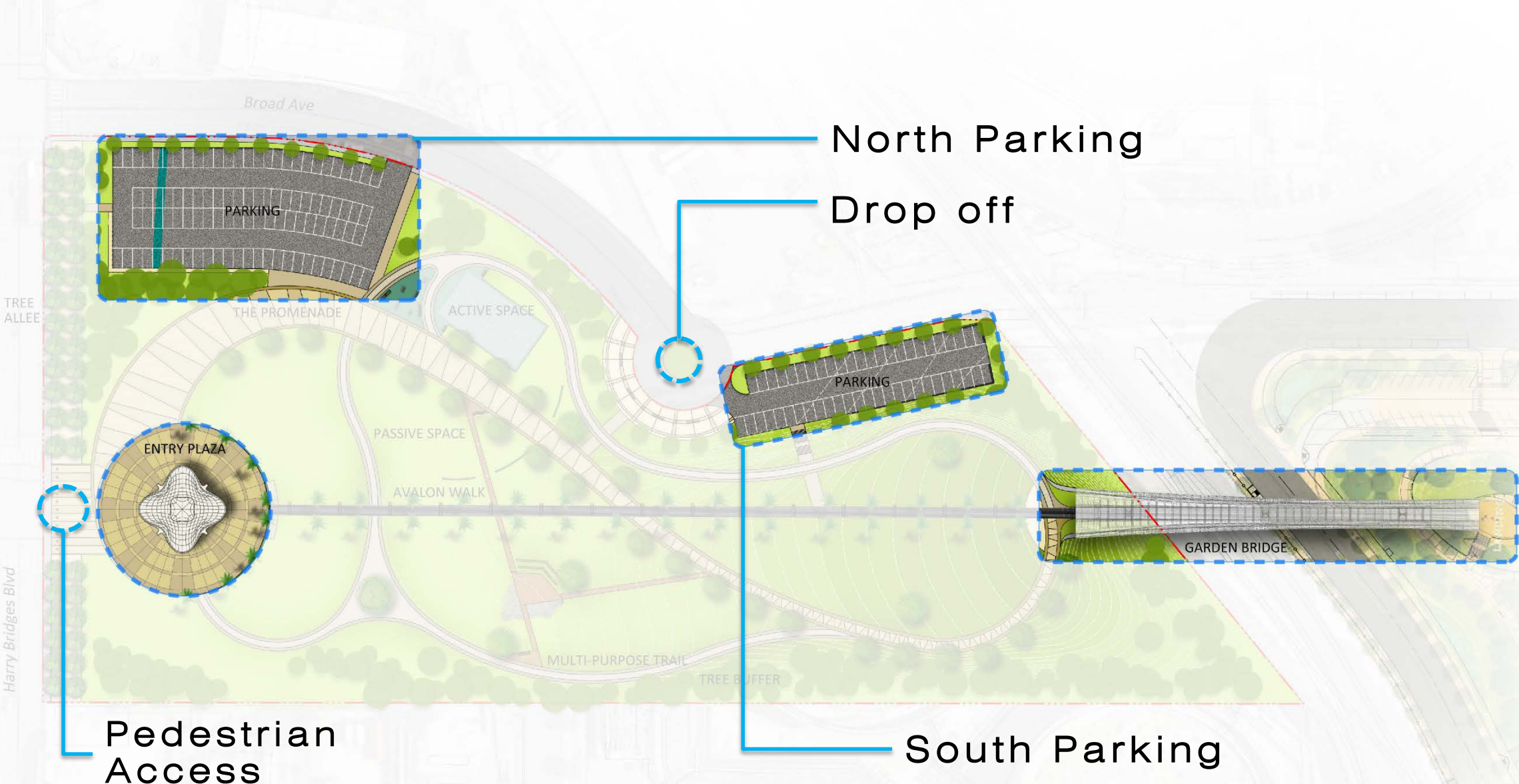

# Park Features

# COMMERCIAL OPPORTUNITIES



# Next Steps

### Avalon Promenade and Gateway

Design Workshop #2 Questionnaire 12/5/17

Port of Los Angeles | Wilmington, CA

Name	(Optional)
Email	(Optional)

#### I. What is your preferred Entry Plaza?

Please place a check mark in the lower right hand box of your preferred Entry Gateway.

A. Whimsical Gateway



B. Sculptured Sundial



COMMENTS:

#### II. What is your preferred Bridge?

Please place a check mark in the lower right hand box of your preferred Bridge.

A. Arch Bridge

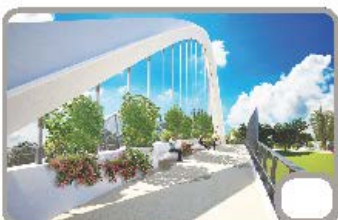

B. Garden Bridge



COMMENTS:

Thank you for your participation. We value your feedback.  
If you have any questions or comments, please contact Hugo Cisneros at [HCisneros@PortLA.org](mailto:HCisneros@PortLA.org).

# Next Steps

Comment Deadline – January 12, 2018

Final Presentation – January 31, 2018 (tentative)